



Sieve and sifter certification
& inspection service.

Applicable industries:



Food



Agriculture



Pharma



Recycling



Plastics



Construction



Glass



Chemical



SPECIFICATIONS:



Apolo sack tip station with integrated sieve shaker, a unit used for receiving bulk materials in various formats with safety sieving.

- Designed to prevent contamination and reduce dust emission.
- Removable enclosure with quick-release closures, allowing operation in four different positions.
- Throughput capacity up to 3,000 kg/hour.
- Manufactured in AISI 304 stainless steel (AISI 316 upon request), with gaskets and components compliant with FDA regulations.
- Available diameter: 800 mm.



TECHNICAL DATA:



- Easy to clean.
- Interchangeable sieves.
- Minimizes product loss.
- Low maintenance.

INCLUDES:



- Sack tip station with orientable enclosure.
- Sieve shaker with central motor.
- EC Declaration of Conformity.
- Instruction manual.

TECHNICAL FEATURES:



Voltage (V)	Current (A)	Power (Kw)	(r.p.m)	Weight (Kg)
380-400	0.6	0.3	1500/1800	177.5

*Other voltages available upon request.

DIMENSIONS:

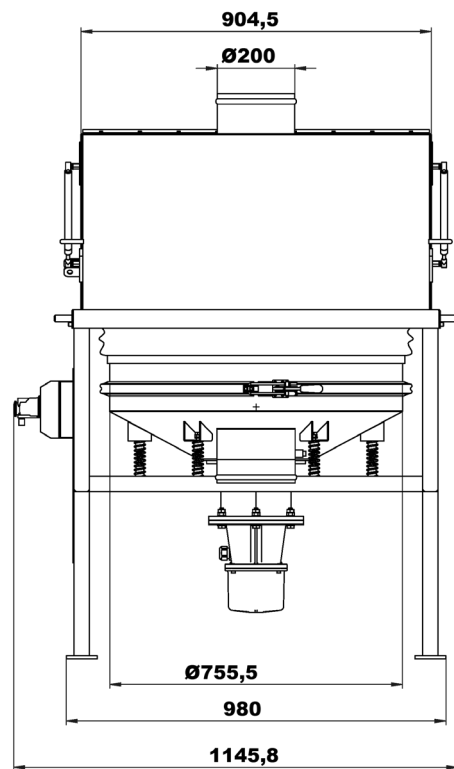
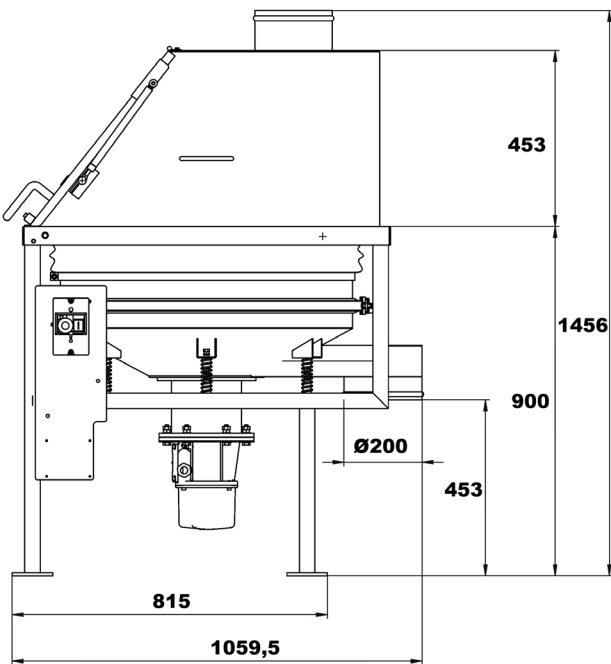

OPTIONAL ACCESSORIES:



ATEX Option

Mesh & sheet metal sieves



Bodies with/without outlets



Neodymium magnet grill for metals



BFM connector (Spigot & sleeves)



Clamp with quick-release and spring



Self-cleaning ring/food-grade rubber balls

