



MINERVA FTIC-650 | FTIC-0800 | FTIC-1200

The "MINERVA" centrifuge sieve shakers are used when high productivity is required, with two types of sieving being possible:

- Separation sieving of different granulometries in products with poor flow characteristics which are difficult to sieve.
- Safety sieving of the finished product in order to eliminate possible impurities.

Used in industrial sectors such as food or pharmaceuticals, etc., they are suitable for a wide range of products such as flours, sugars, ceramics, varnishes, pigments, plastics, etc.

The product to be sieved is conveyed to the centre of the cylinder and is distributed over the whole sieve surface, via adjustable paddles. The velocity of the paddles creates a centrifugal force which pushes the product through the mesh. The largest particles or those with impurities are thrown out.

The velocity and the paddles can be adjusted to the type of product. It is manufactured in AISI 304 stainless steel or AISI 316 under request.

If the centrifugal sieve is going to be used in areas classified as being potentially explosive environments then it is manufactured accordingly and carries the ATEX certificate.

Equipment suitable for pneumatic transport, either impulsion +0.8bar or aspiration -0.5bar.



TECHNICAL FEATURES

FTIC-0650	380/400 V	50 Hz	690 rpm	1,1 kW
FTIC-0800			850 rpm	2,2 kW
FTIC-1200			-	4 kW

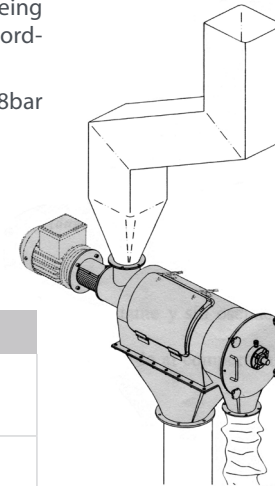

TECHNICAL DIMENSIONS

(mm)	FTIC-0650	FTIC-0800	FTIC-1200
A	840	945	1200
B	1875	2200	2500
C	140	220	250
D	150	165	180
E	250	245	380

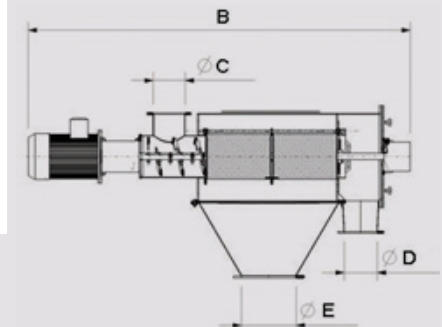
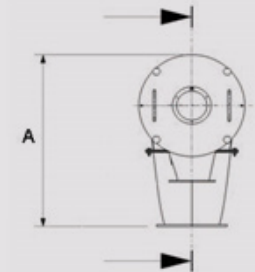

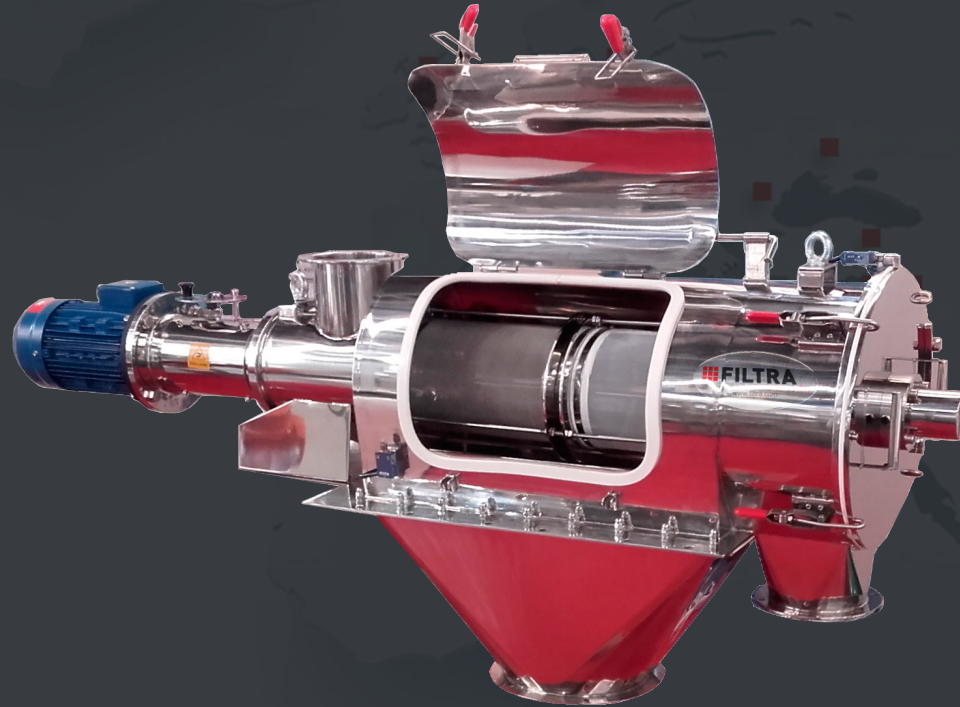

SIEVING FOR LABORATORY AND INDUSTRIAL PROCESSES

FILTRA
VIBRACIÓN

Filtra Vibración S.L

C/ BRONZE, 1-3, P.I. LES GUIXERES
08915 BADALONA (BARCELONA)

filtra@filtra.com
filtra.com